

(

[behringer.com](http://behringer.com))



# EUROPORT EPA900/EPA300

- 8/6-  
900/300  
FBQ.

RU

RU



1/4" TS "speakon".



- 1.
- 2.
- 3.
- 4.
- 5.
- 6.
- 7.

8.

9.

10.

11.

12.



13.

14.

15.

16.



BEHRINGER  
MUSIC GROUP (MUSIC-GROUP.COM),

MUSIC GROUP

MUSIC GROUP

MUSIC GROUP

MUSIC GROUP IP LTD.

© 2013 MUSIC Group IP Ltd.  
Trident Chambers, Wickhams Cay,  
P.O. Box 146, Road Town, Tortola,  
British Virgin Islands

Music Group

[www.music-group.com/warranty](http://www.music-group.com/warranty).

RU

# EUROPORT EPA900/EPA300

1:

1

2

3

4

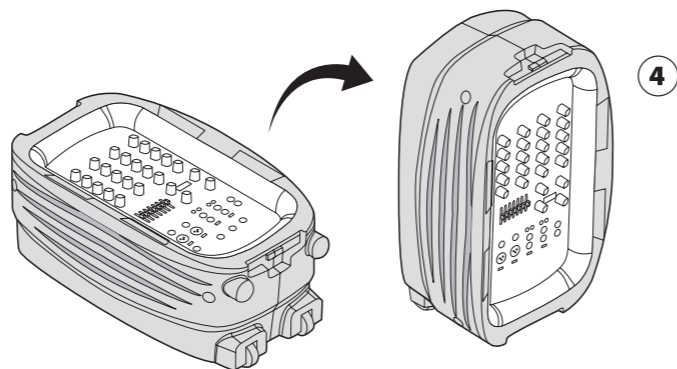
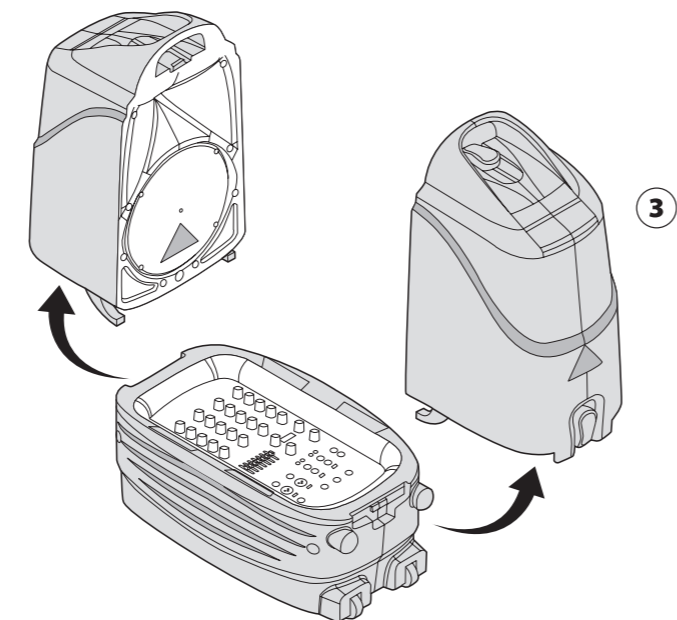
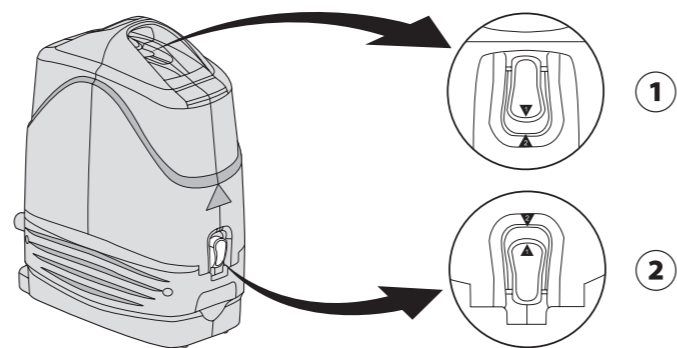

"EPA900 (в модели EPA300 нет колесиков)"

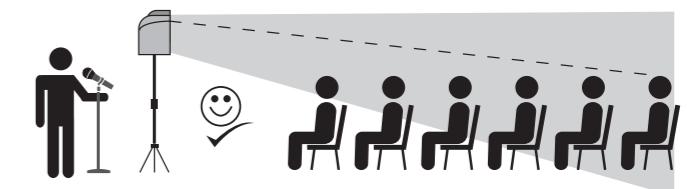
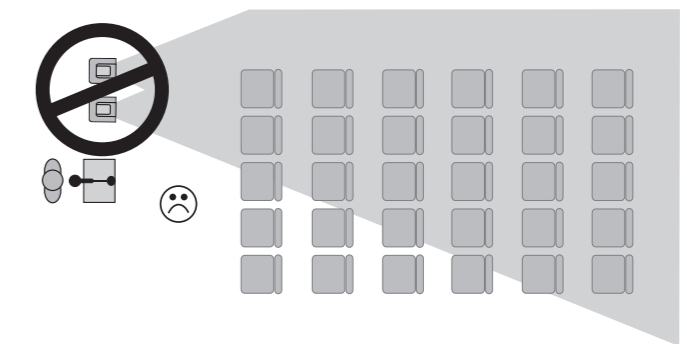
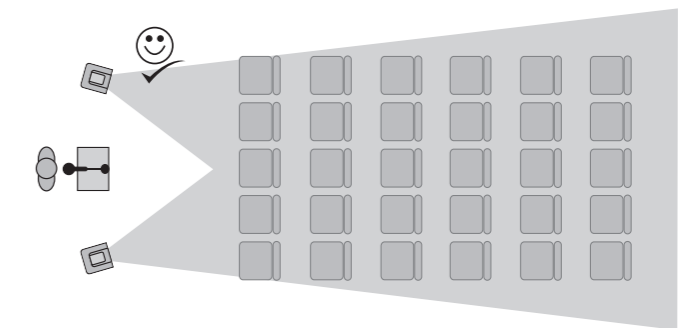
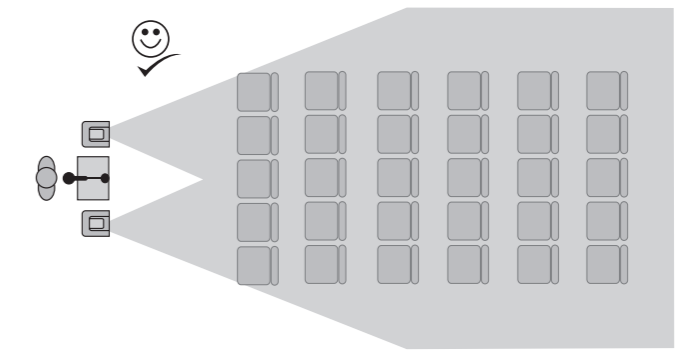

# EUROPORT EPA900/EPA300

2:

EFFECTS

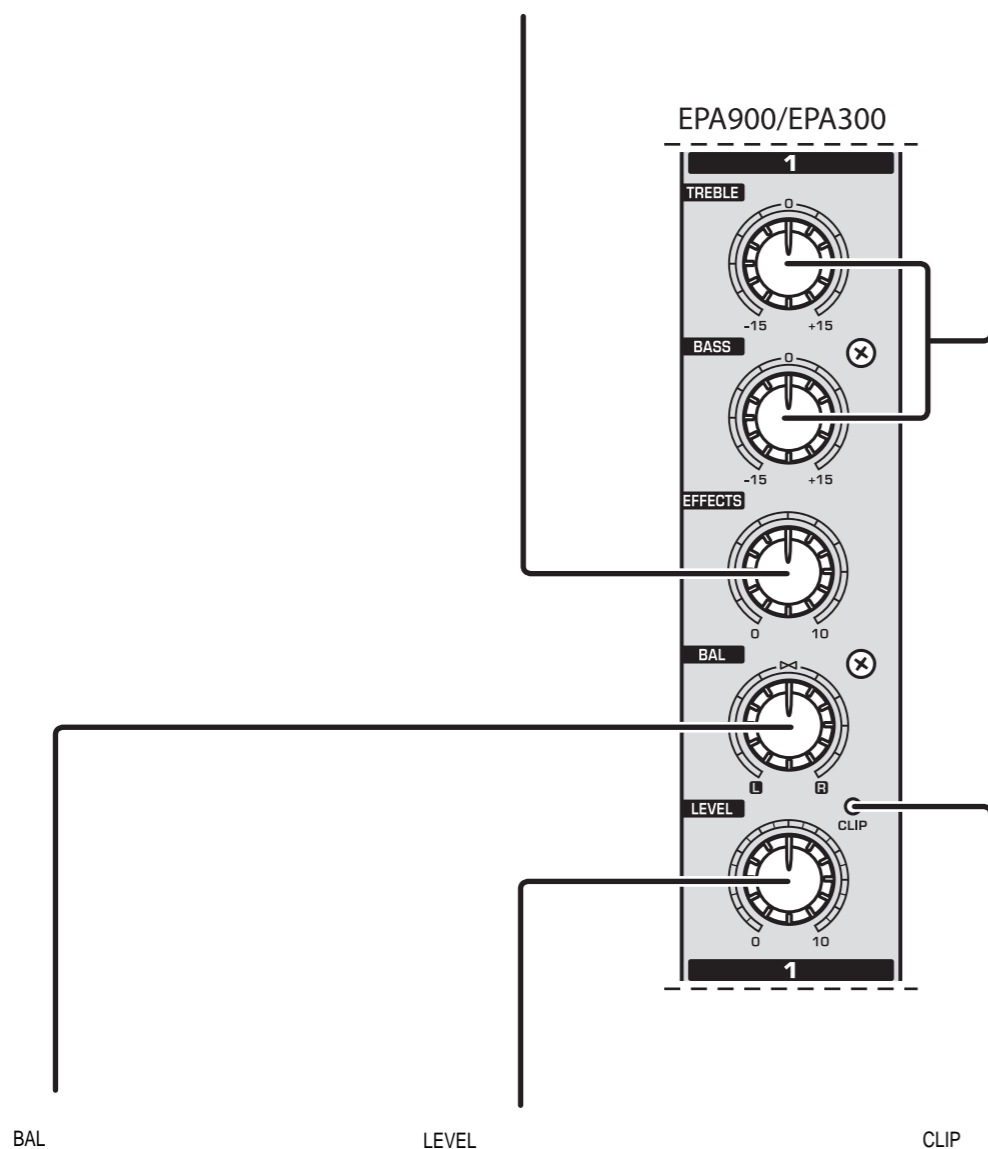

PROGRAM [PUSH]

EFFECTS [LEVEL]

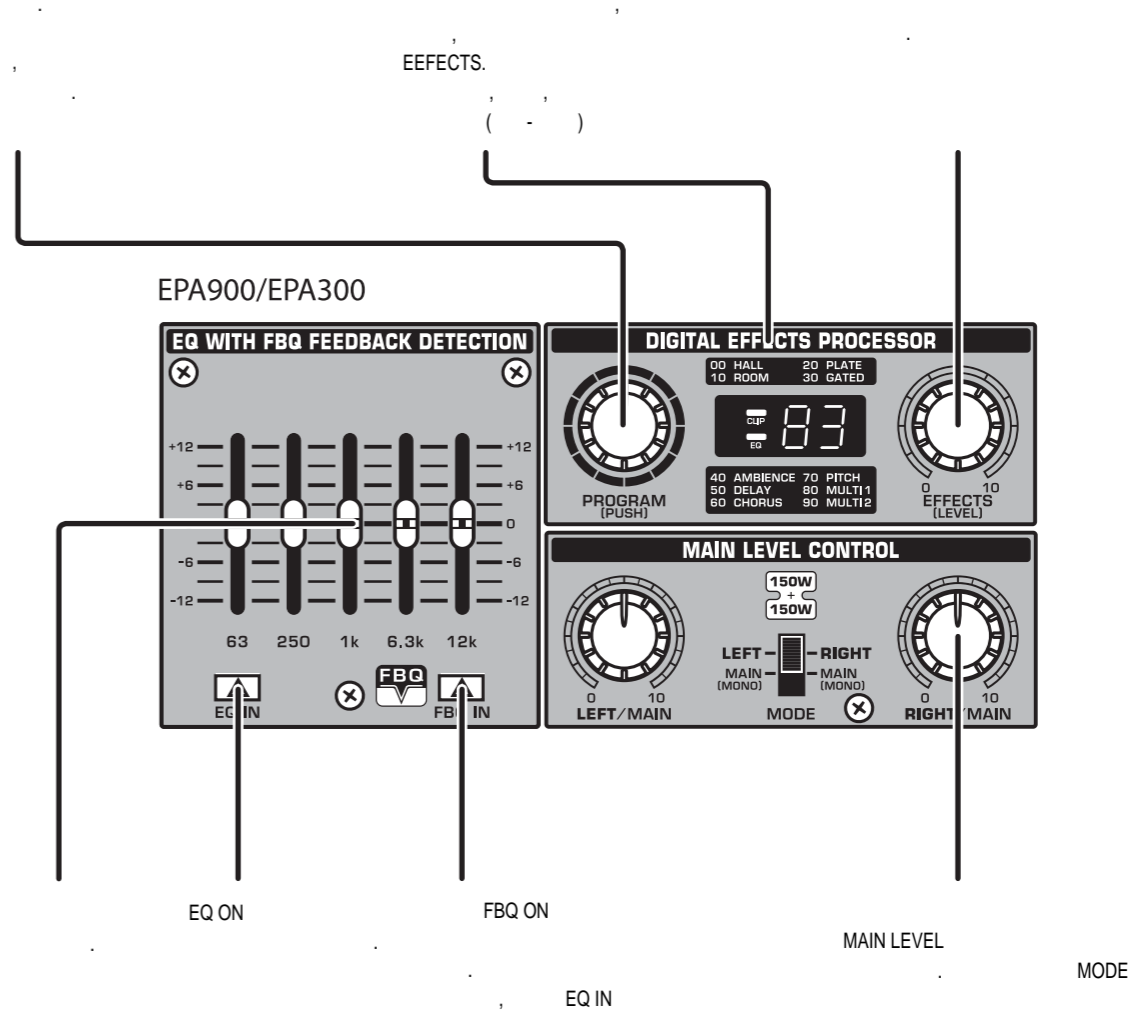

# EUROPORT EPA900/EPA300

2:

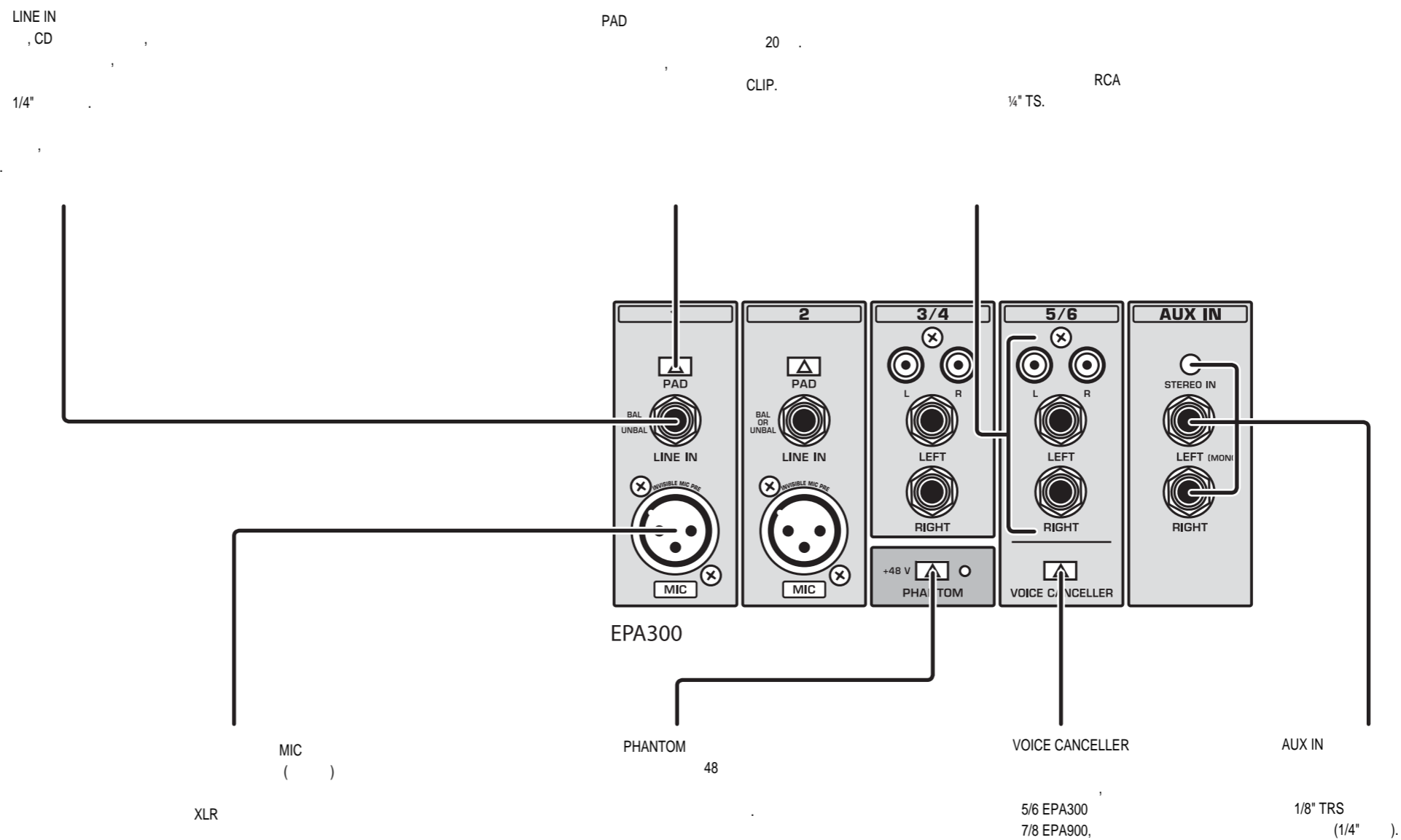

# EUROPORT EPA900/EPA300

2:

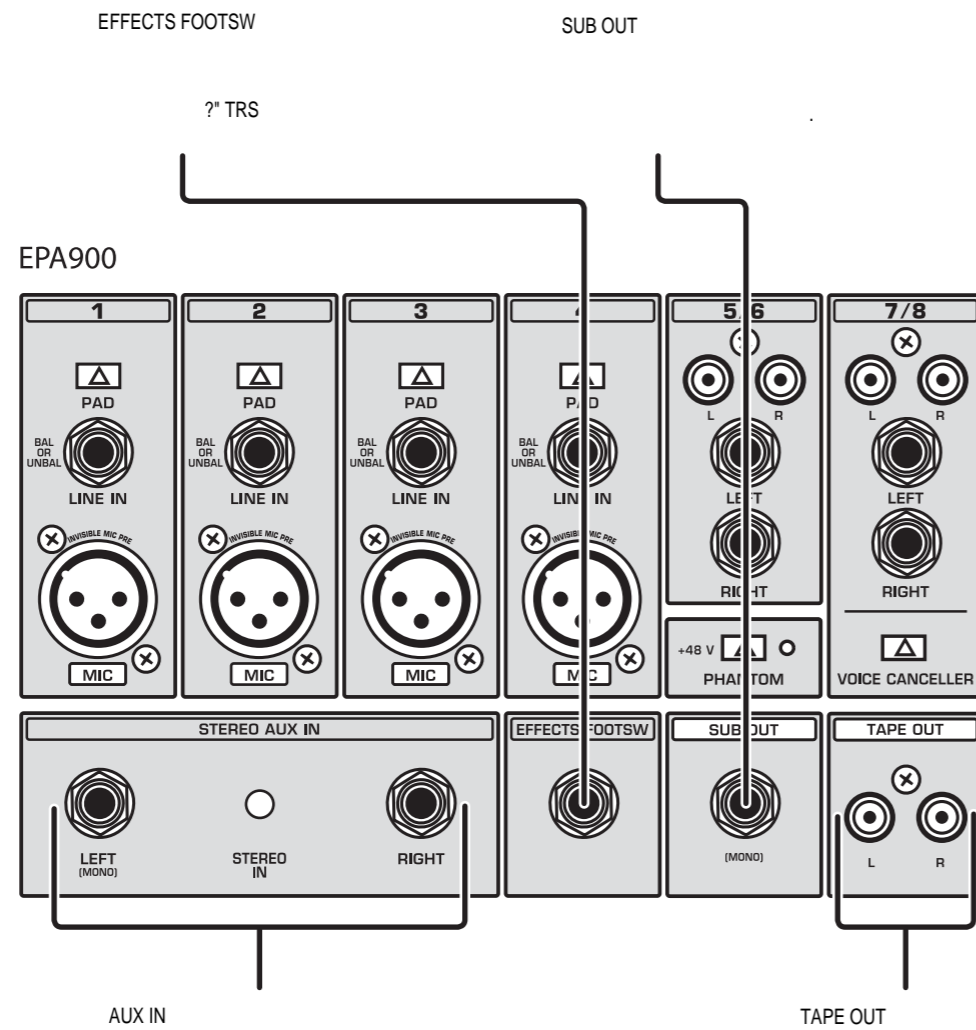

1/8" TRS,  
(1/4" ).

SPEAKER OUTPUTS

1/4"

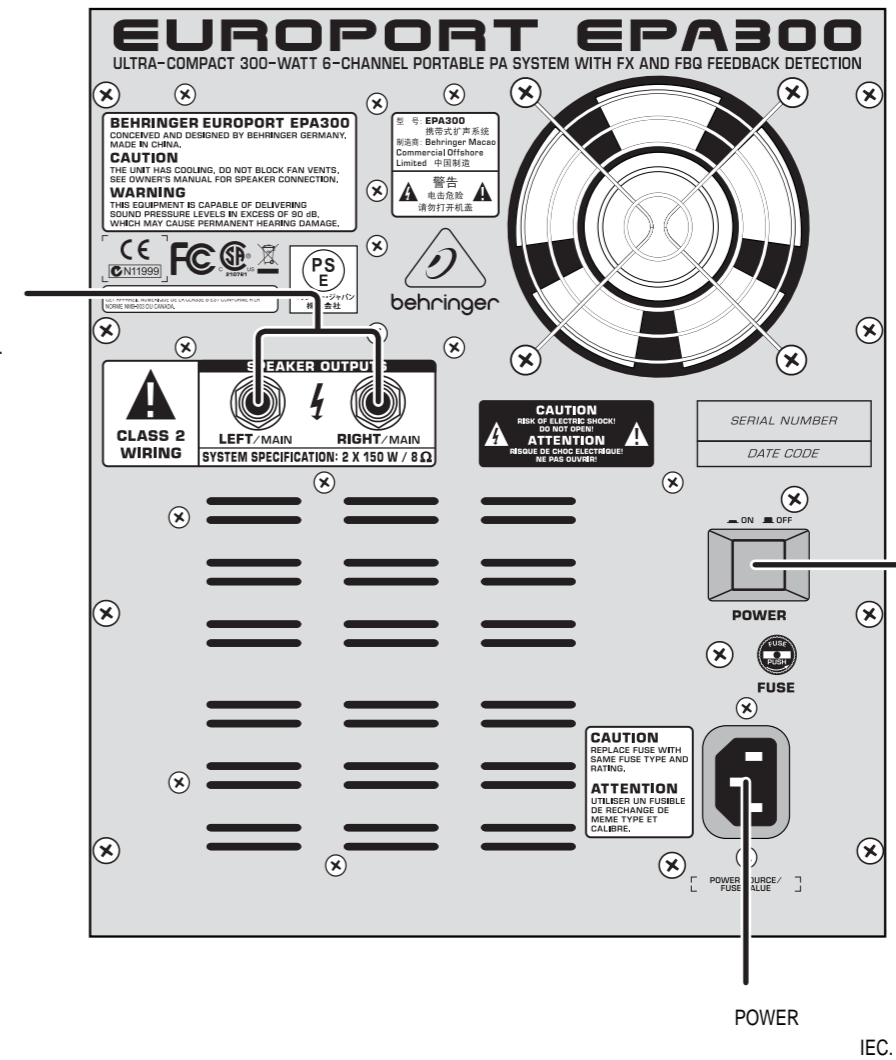

POWER

IEC.

# EUROPORT EPA900/EPA300

3:

**1**

SPEAKER OUTPUTS

**2**

**3**

(TREBLE ( ), BASS ( ), BAL ( )  
EFFECTS LEVEL ( )

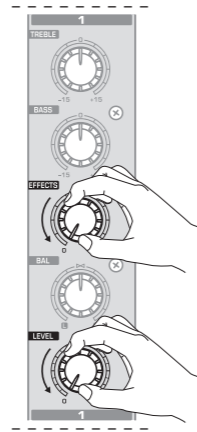

**4**

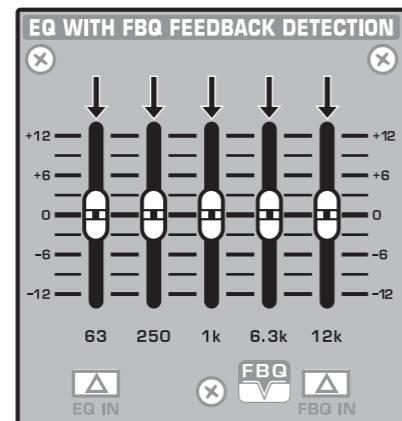

**5**

MAIN LEVEL

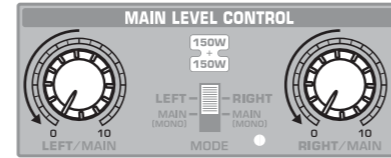

**6**

**7**

POWER.

EPA300,

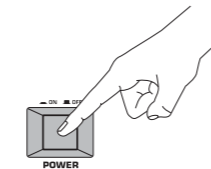

**8**

MAIN LEVEL  
1/3.

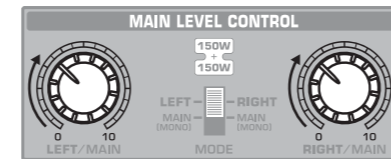

**9**

LEVEL

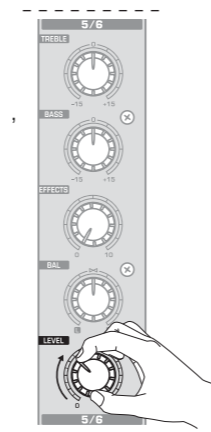

**10**

PAD. CLIP, PAD

LEVEL.  
PAD

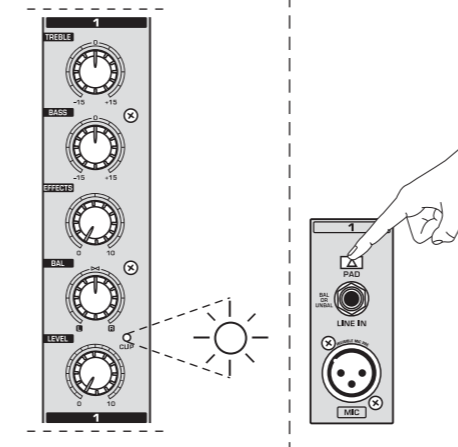

**11**

BAL.

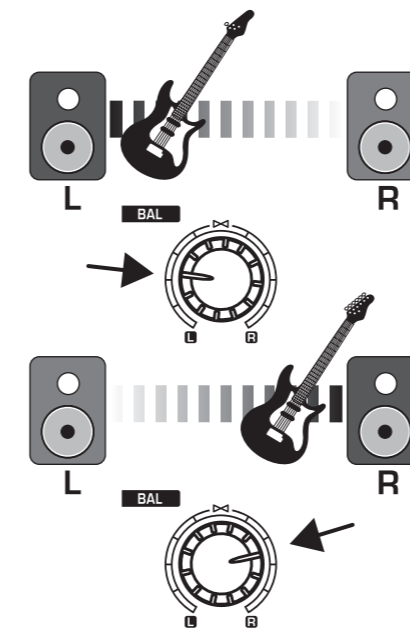

**12**

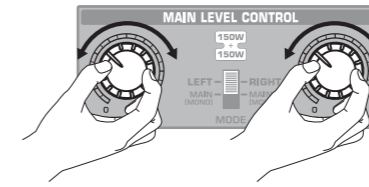

# EUROPORT EPA900/EPA300

4:

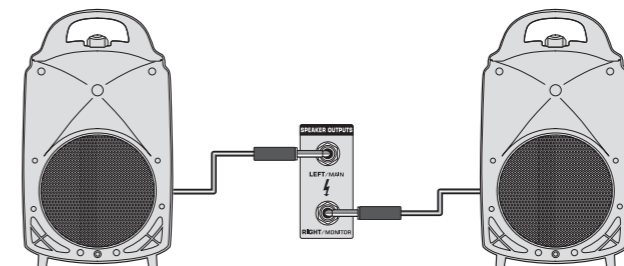
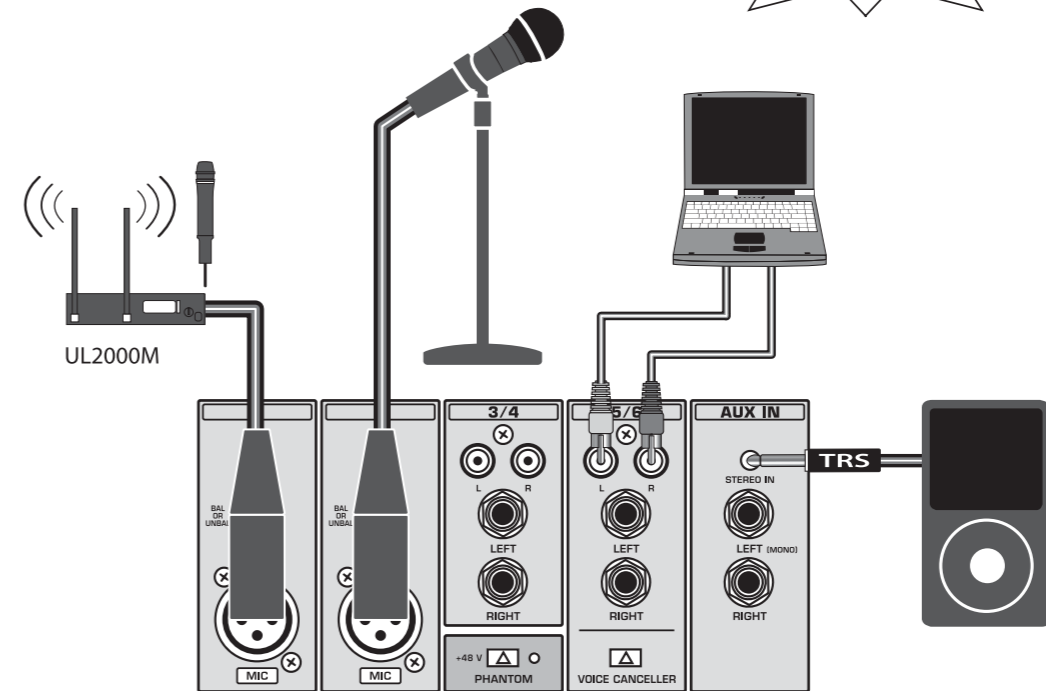
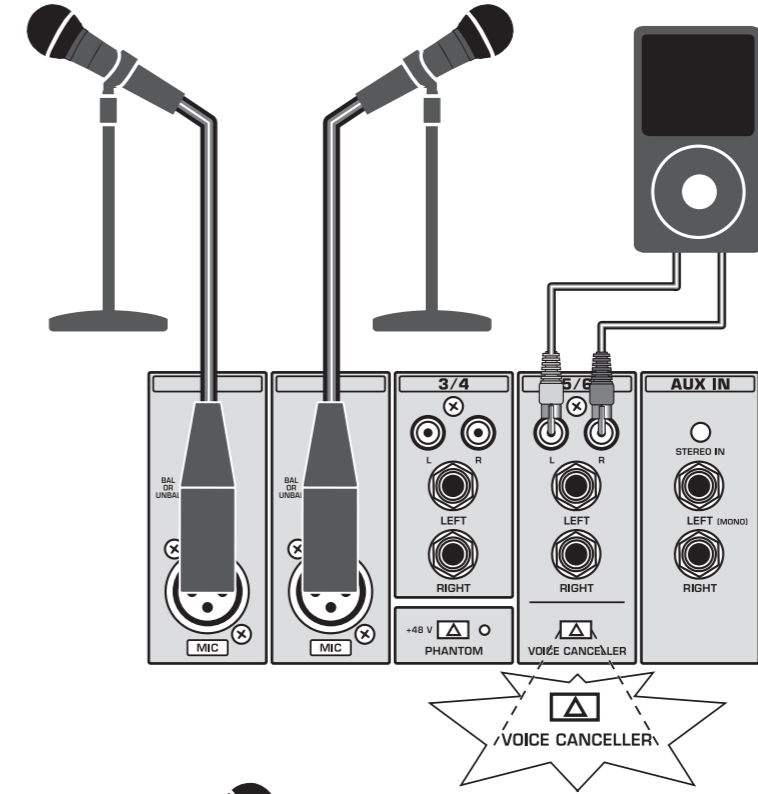
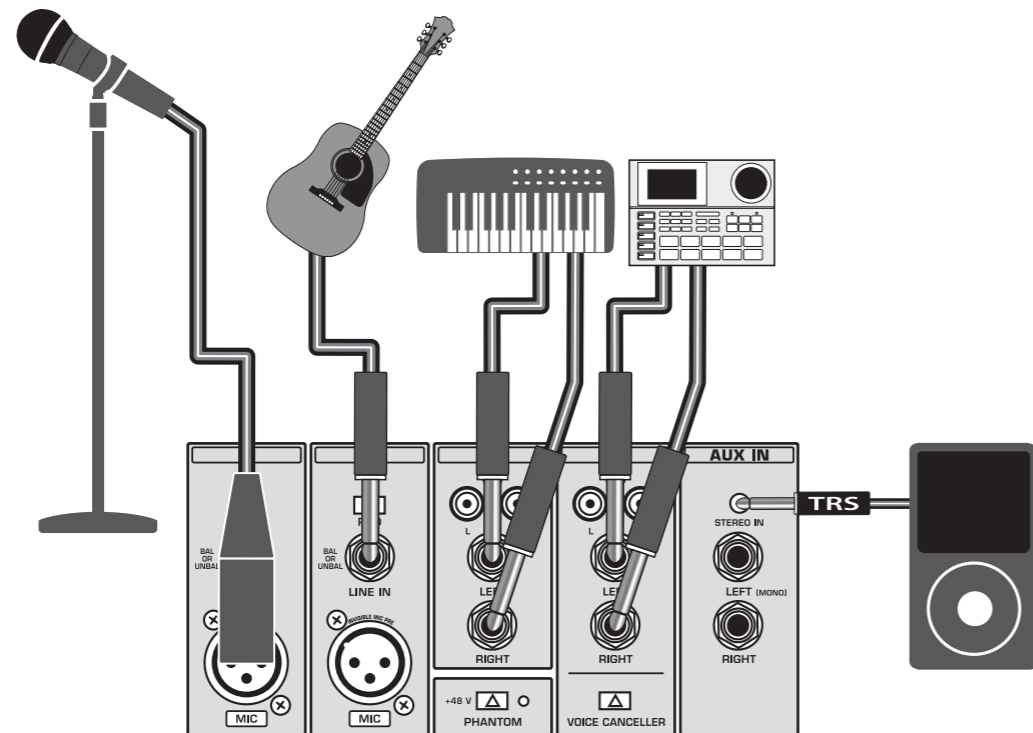
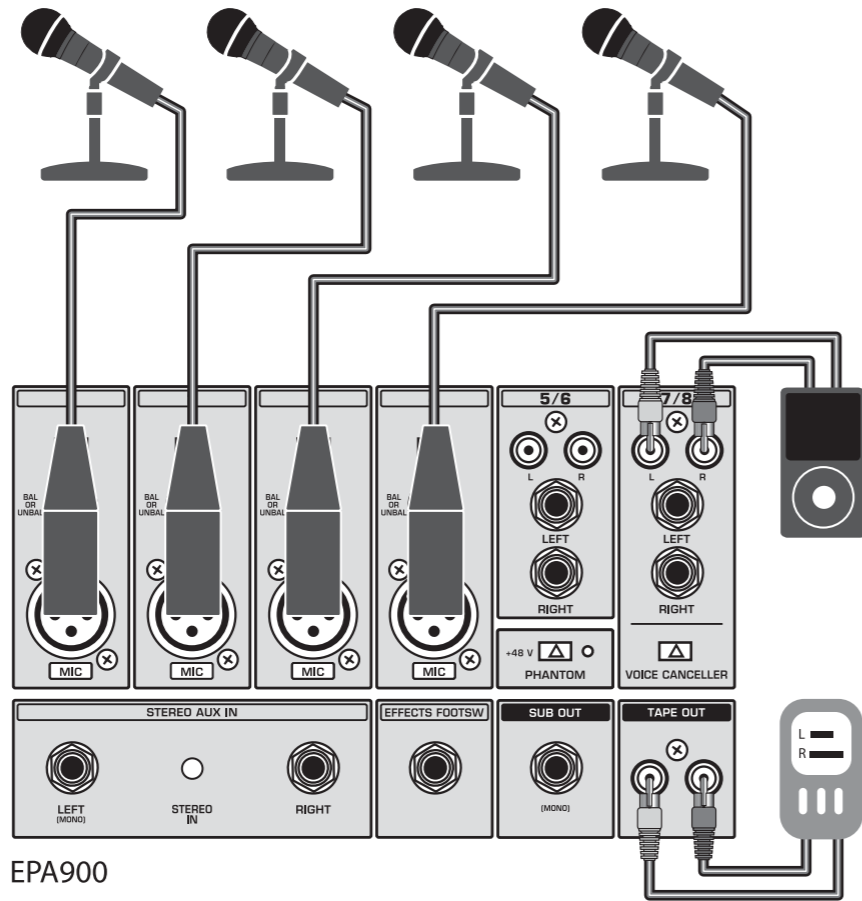



# EUROPORT EPA900/EPA300

5:

**1** [LEVEL] EFFECT  
75%.

**5** EFFECT [LEVEL]  
75%

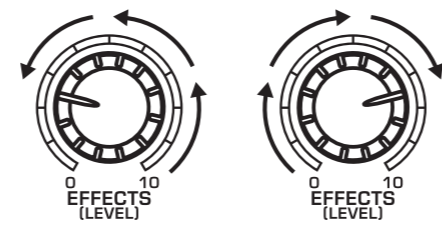
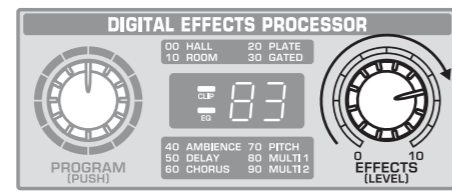

**2** PROGRAM [PUSH].

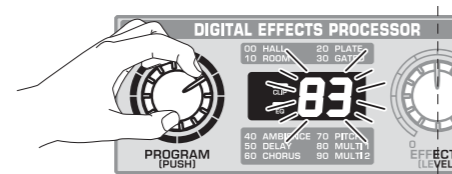

**3** PROGRAM [PUSH].

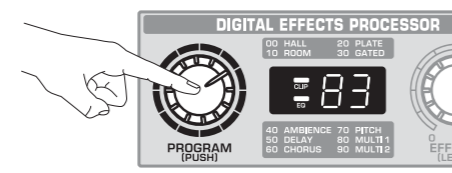

**4** EFFECTS

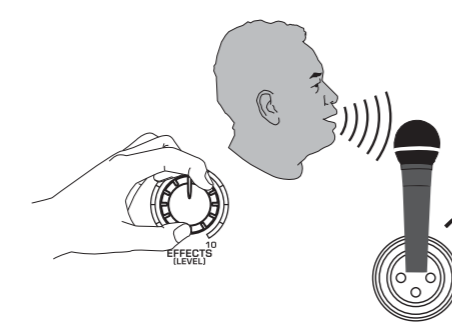

# EUROPORT EPA900/EPA300

6:

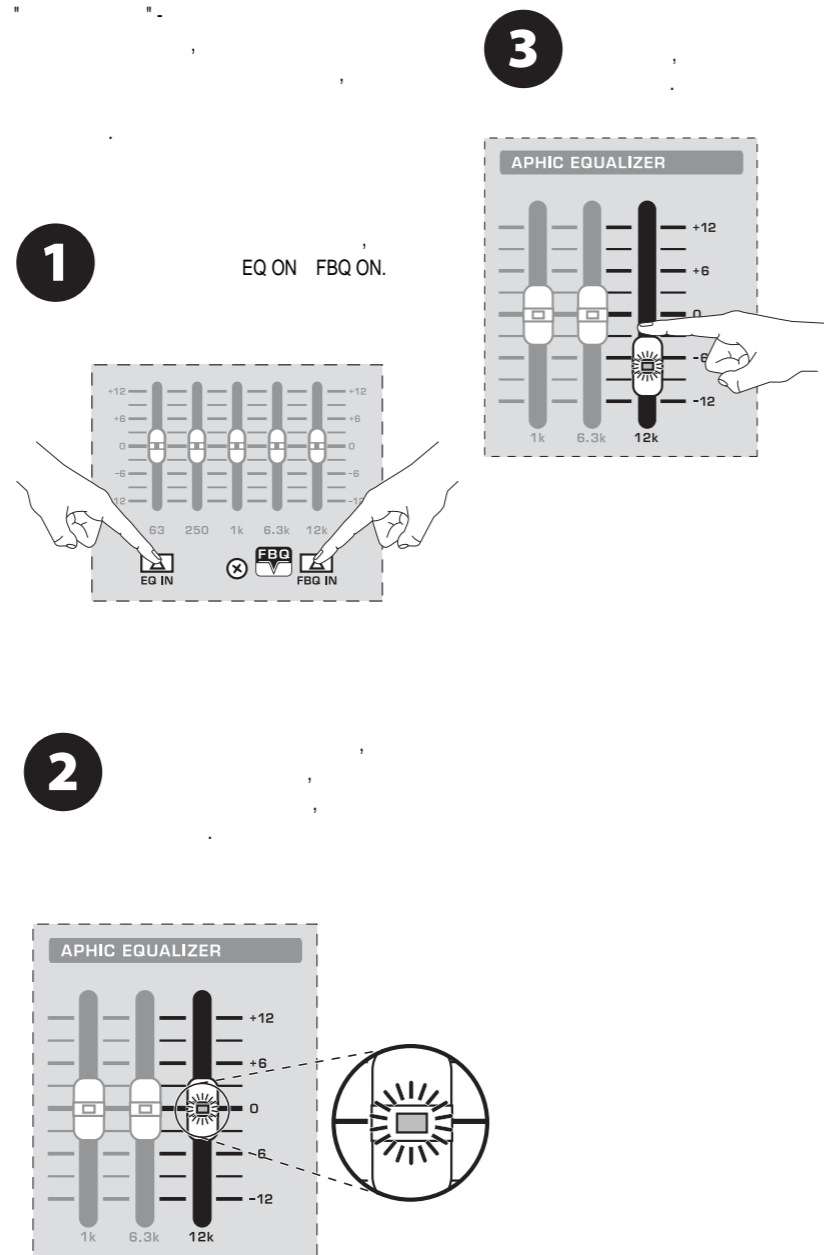

	EPA900	EPA300
	<b>1-4</b>	<b>1-2</b>
	XLR 4 . TRS ¼" 4 ..	XLR 2 . ¼" TRS 2 ..
	5/6, 7/8 ( )	3/4, 5/6 ( )
	¼" TS 4 .. RCA 4 ..	¼" TS 4 .. RCA 4 ..
	<b>Aux In</b>	<b>Aux In</b>
	¼" TS 2 .. 1 x 1/8" TRS,	¼" TS 2 .. 1 x 1/8" TRS,
	¼" TRS 1 ..	
	RCA 2 ..	
BASS ( ):	±15 80	±15 80
TREBLE ( ):	±15 12	±15 12
	7	5
	24 -	24 -
	40	40
	2 ,7	2 ,7
	<b>RMS</b>	<b>RMS</b>
	160 8	130 8
	300 4	
	260 8	150 8
	450 4	
	50 25	50 25
	< 0.5% THD 280	< 0.5% THD 120
/	85 ,	90 ,
	¼" TS,	¼" TS,
	261	217
	1,35" (34 )	1,35" (34 )
/ ( )		
/	120 ~, 60 (T 10 A H 250 )	120 ~, 60 (F 5,0 A H 250 )
/	240 ~, 50 (F 6,3 A H 250 )	240 ~, 50 (F 3,15 A H 250 )
( )	230 ~, 50 (F 6,3 A H 250 )	230 ~, 50 (F 3,15 A H 250 )
	100 ~, 50/60 (T 12 A H 250 )	100 ~, 50/60 (F 5,0 A H 250 )
:	. 1000	. 320
	IEC	IEC
/		
( )	660 x 354 x 883	672 x 520 x 304
	31	20,6

RU

1.   
 ,   
 .   
 MUSIC Group,   
 behringer.com.

2.   
 .   
 MUSIC Group,   
 .   
 behringer.com. "Support"   
 .   
 "Support"   
 behringer.com.

3.   
 .   
 .



: **MUSIC Group Services US Inc.**  
 : **18912 North Creek Parkway,**  
 : **Suite 200 Bothell, WA 98011,**  
 : **USA**  
 : **Phone: +1 425 672 0816**

**EUROPORT EPA900/EPA300**

FCC,

15 FCC

( )

- 
- 
- 
- 

15 FCC.

- (1)
- (2)

MUSIC Group,

